



ATTACHMENT OPERATORS MANUAL

ATTACHMENT.....

SERIAL NUMBER.....



WHITES MATERIAL HANDLING Ltd.
17-19 EMERY ROAD
BRISLINGTON,
BRISTOL. BS4 5PF. U.K.
TEL. +44(0) 117 972 0006

<http://www.whitesmh.co.uk>



PART NUMBER:- WHCE0264

OPERATORS MANUAL

FOREWORD

In these Safety and Operating Instructions the following words are defined as follows:-

'ATTACHMENT':- A bucket or attachment which is classed as a machine under the CE machinery Directive.

Attachments covered under these Safety and Operating Instructions are 4 in 1-multipurpose buckets, high tip buckets, side tip buckets, pallet fork attachments, broom buckets, angled brooms, fork and grapples, industrial grapples, and all other attachments which are classed as a 'machine' under the CE Machinery Directive.

'MACHINE' or **'HOST MACHINE'**:- A wheeled or tracked loading machine (skid steer, backhoe loader, articulated loader) which connects to and powers the attachment.



WARNING

INCORRECT USE OF THIS ATTACHMENT OR FAILURE TO FOLLOW INSTRUCTIONS CONCERNING SAFETY CAN LEAD TO SERIOUS INJURY OR DEATH.

BEFORE USING THIS ATTACHMENT:-

- 1. READ THIS MANUAL CAREFULLY.**
- 2. MAKE SURE THAT THIS ATTACHMENT IS SUITABLE FOR USE ON THE HOST MACHINE.**
- 3. CLEAR THE AREA OF OTHER PERSONS.**
- 4. LEARN AND PRACTICE SAFE USE OF THIS ATTACHMENT AND HOST MACHINE IN A CLEAR AREA BEFORE YOU OPERATE THIS MACHINE ON A JOB SITE.**
- 5. IT IS YOUR RESPONSIBILITY TO OBSERVE PERTINENT LAWS AND REGULATIONS IN RESPECT OF THE OPERATION OF THIS ATTACHMENT AND THE HOST MACHINE.**

TO THE OWNER

You are the owner of an attachment that has been built to operate correctly on your host machine.

The attachment conforms to current safety regulations (see OFFICIAL JUSTIFYING DOCUMENTS on the following page).

However, this does not exclude all risk of accidents, which is why it is essential to observe elementary safety rules and precautions.

Before putting this attachment into service please ensure that:-

1. The operator has read and fully understands this operator's manual.
2. The operator has received necessary training on the functions and capabilities of this attachment.
3. The information on the identification plate, which is fixed to the rear top left corner of the attachment, matches the information on the EC Declaration of Conformity.

OFFICIAL JUSTIFYING DOCUMENTS

EC DECLARATION OF CONFORMITY



Buckets and Attachments for all types of Loading Machines

Whites Material Handling Ltd
17-19 Emery Road
Brislington Trading Estate
Bristol BS4 5PF, United Kingdom
Telephone: +44 (0)117 9720006
Fax: +44 (0)117 9723296
Email: sales@whitesmh.co.uk
Internet: www.whitesmh.co.uk

UKCA	CE
-------------	-----------

DECLARATION OF CONFORMITY

DATE OF MANUFACTURE.	CERTIFICATE/SERIAL N
26/11/2021	W0257550-1

	DESCRIPTION
WHITES PART NUMBER	BBS76/WHI
CUSTOMER PART NUMBER/ DESCRIPTION	BUCKET BBS76/SWEEP 2290mm (7'6")
TO FIT MACHINE	
WEIGHT -kg	22

EXAMPLE

We, WHITES MATERIAL HANDLING LTD., declare under our sole responsibility that the product detailed above corresponds to the relevant basic safety and health requirements of the Directive 2006/42/EC and that the following standards and/or technical specifications have been respected - BS EN474-1:2006 +A4:2013

FOR AND ON BEHALF OF WHITES MATERIAL HANDLING LTD

MARTIN COLES, Project Engineer

-SAFETY (automatically certified as per 89/392/EEC.)

Attachment	<input type="text"/>	<input type="text"/>	Serial Number
Part Number	<input type="text"/>	<input type="text"/>	Date Of Manufacture
S.W.L (pallet fork attachment) [Kg]	<input type="text"/>	<input type="text"/>	Max Hyd Pressure [Bar]
MASS (WEIGHT) [Kg]	<input type="text"/>	<input type="text"/>	Capacity [m ³]
To Fit Machine	<input type="text"/>		



Manufacturer / Supplier:
Bristol, BS4 5PF, UK



Tel . +44 (0)117 972 0006
sales@whitesmh.co.uk



ATTACHMENT IDENTIFICATION PLATE:- Part No. WH-CE-0208

LOADER MOUNTED ATTACHMENTS

1. SAFETY
2. OPERATING INSTRUCTIONS
3. MAINTENANCE
4. SUPPLEMENTARY INSTRUCTIONS

1. SAFETY

1.1 GENERAL: This attachment has been designed and built according to the state of the art and meets current safety regulations in force. However, this does not completely exclude the risk of accidents. It is therefore essential to follow basic safety rules and precautions.

The strict execution of the instructions provided in this manual will prevent accidents during attachment use and maintenance operations.

These instructions will only be effective if the attachment receives proper maintenance. Any defects or anomalies must be repaired immediately.

Only use this attachment for the purpose for which it was designed.

1.2 BEFORE YOU OPERATE THE ATTACHMENT: Please be aware that this attachment is designed to be used in conjunction with the host machine. It is essential, therefore, to be fully conversant with the correct operating procedures and safety instructions of the machine. Familiarise yourself with the attachment, and the loads to be carried.

Always follow the machine manufacturers' instructions in relation to connection, disconnection and operation of attachments.

Be prepared for emergencies. Always carry a first aid kit and a good fire extinguisher with you and know how to use them.

1.3 OPERATING THE ATTACHMENT:

! NEVER GET ON OR OFF A MOVING MACHINE

Keep all tread plates clean and free from grease, mud and (in winter), snow and ice.

Get to know the machines possibilities and the working space required.

Always wear the correct protective clothing relevant to the working conditions.

Dust, fog, smoke etc. can reduce visibility and cause an accident. Operate with extreme caution in these conditions.

Before starting work, check that the attachment is properly connected to the host machine and that all the functions operate correctly. See the machine manufacturer's manual for the correct connecting procedure.

Never carry any person on the attachment.

Make sure there is nobody standing near the attachment.

Do not allow anyone to stand in the 'Danger Zone' (operating area).

Do not jump off the attachment - you can get hurt.

Keep away from dangerous areas, such as ditches, over-hangs, cliffs, etc. Look for hazards.

Use all the controls gradually so that the attachment works smoothly.

When operating or servicing an attachment, wear suitable protective clothing.

1.4 MAINTENANCE:

! BEFORE CARRYING OUT ANY SERVICE WORK ON THE ATTACHMENT:

- ***Park the host machine on a hard level surface.***
- ***Lower the attachment to the ground.***
- ***Apply the parking brake and shut down the engine.***
- ***Block the machine to prevent any movement.***

When servicing the attachment, place a 'DO NOT START UP' label on the control panel of the machine.

Modifying the attachment without prior permission can cause serious injury. Do not undertake any modification without prior authorisation from White's or their Approved Agent.

Always wear eye protection when using a tool that may project metal particles. Use a hammer with a soft face, such as copper, for installing pins.

Pressurised hydraulic fluid or grease, which penetrates the skin can cause serious injury. Take the necessary safety precautions (safety clothing and protection for the face and hands) to avoid such risks. Also, before using these products, read the manufacturer's instructions for their use. If hydraulic fluid penetrates the skin, call a doctor immediately.

1.5 FAILURE DURING OPERATION: If an attachment failure occurs during operation, disconnect the attachment from the host machine and take measures against its' use until a satisfactory repair has been carried out.

1.6 SAFETY DECALS:

**! An illegible or missing decal may have serious consequences.
Replace safety decals that are missing or damaged.**

DECAL SHEET – WH-CE-SHGX

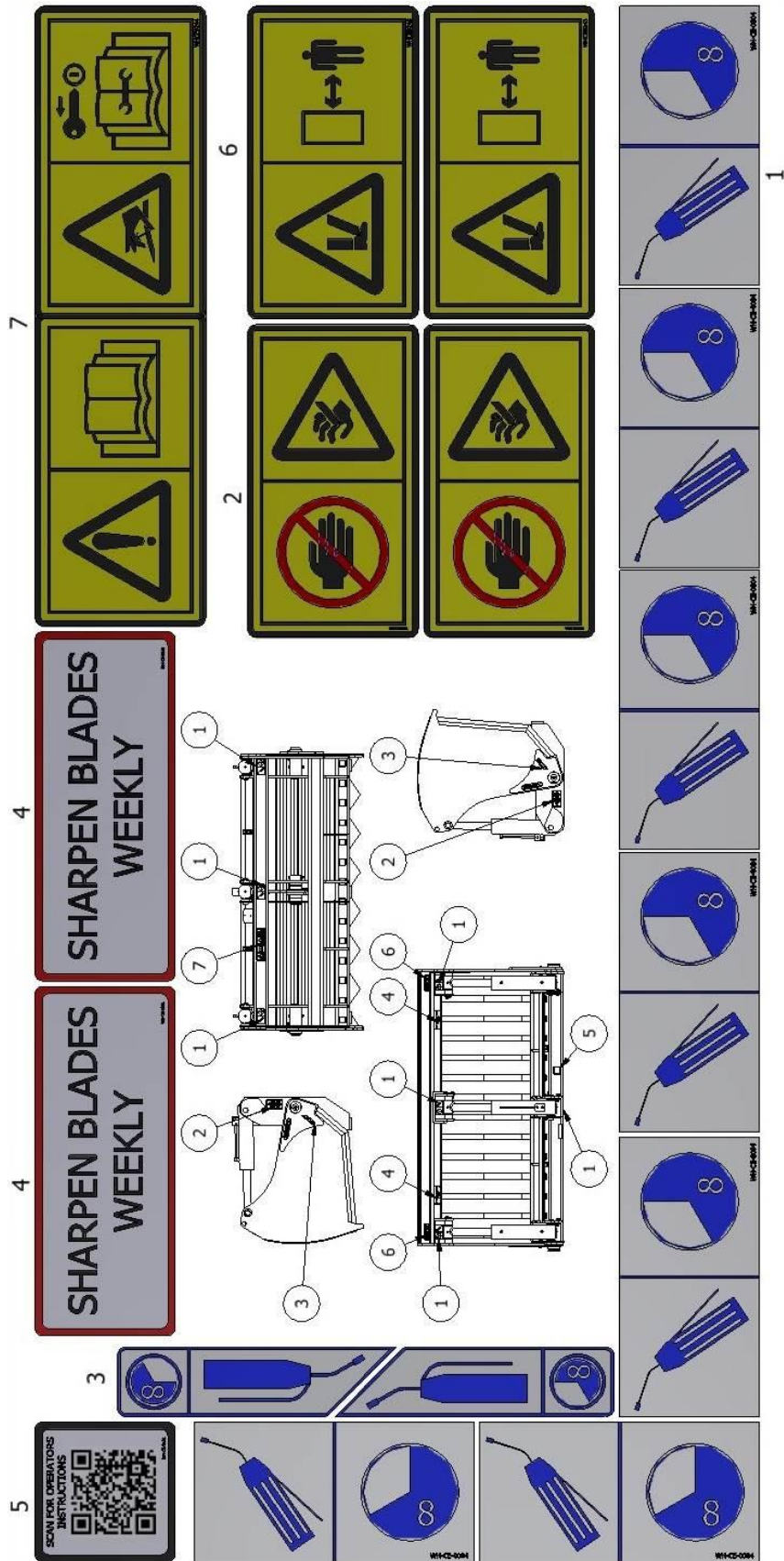

2. OPERATING INSTRUCTIONS

2.1. INSPECTION:

UPON DELIVERY:-
Check for transit damage.
Check hydraulic system for any damage or leaks.
Remove transport bolts

DAILY INSPECTIONS:-
Check for hydraulic leaks.
Check for insecure bolts, nuts and pins.
Check for missing parts.

MONTHLY INSPECTIONS:- Check for excessive wear on cutting edges, teeth or tines. Replace with genuine spares when necessary.

2.2 APPLICATION: For all earth moving, and load handling operations refer to the machine manufacturer's handbook for correct use of machine and its' controls.

Ensure that the attachment is suitable for the work in hand. e.g. check that the capacity of the attachment is matched to the density of the load.

Always carry the load low!

2.3. SITE FAMILIARITY: Before operating the machine and attachment on a new site, check and locate any holes, obstacles, and debris that could be in the machine area,

Locate any unavoidable 'danger areas' (electric power lines, bridges, tight corners, etc.) and make sure you can work safely in these areas.

Electric power lines, gas pipes, water pipes or other underground installations can cause injury or death. Find out about the location of underground installations before you operate the attachment in a new area.

Be aware of people in the vicinity of the attachment. Send away those whose presence is not required.

2.4. NORMAL USE:

! Hillside operation can be dangerous. Rain, snow, loose gravel or soft ground change working conditions. Before you work on a hillside, make sure the attachment can be operated safely.

This attachment is designed to operate with the host machine under normal working conditions. Care should be taken if weather or site conditions become difficult.

Operate the attachment carefully and smoothly in poor weather and on uneven sites.

2.5. OTHER USES: This attachment is designed for a specific application. Do not carry out different applications with this attachment before first checking with Whites or their Agent.

2.6. HANDLING AND TRANSPORTATION: Buckets and attachments can become unstable when not connected to their host machine. Great care should be taken when handling or transporting buckets and attachments. Personnel should be made aware of the risk of injury if due care is not taken. When transporting, always ensure that the attachments are securely strapped or roped to the carrying vehicle.

3. MAINTENANCE

! Never attempt to service a hydraulic circuit component without having first made sure it is no longer under pressure. To do this, carefully read the following instructions.

3.1. GENERAL INSTRUCTIONS: Attachments which operate with hydraulic power are supplied through the auxiliary hydraulic system of the host machine.

Connection to the auxiliary hydraulic circuit is by means of quick release couplers.

To connect or disconnect the quick couplers the operator has to relieve the hydraulic pressure in the host machine. To relieve pressure, please see machine manufacturer's instruction manual.

Regularly check the attachment for signs of damage or wear. Repair or replace damaged components immediately.

If welding repairs are necessary, please observe the following points:-

1. Remove attachment from host machine.
2. Always employ a competent and fully qualified welder to carry out the repair.

When ordering replacement parts always quote the part number and attachment serial number.

3.2. LUBRICATION: DAILY OR EVERY 8 HOURS OPERATION:- Grease all hinge and hydraulic cylinder swivel points with Molydisulphide Grease.

3.3. GROUND ENGAGING COMPONENTS: Excessive wear to bucket cutting edges & teeth, and tines on fork and grapples will lead to reduced performance. Replacing these parts when necessary, will increase performance, and reduce wear and tear to the host machine.

4. SUPPLEMENTARY INSTRUCTIONS FOR THE OPERATION OF SHEAR GRABS

4.1. SAFETY

- 1) It is essential that before operating this attachment the operator is fully capable of safely operating the host machine.
- 2) The operator should also be aware that the clamping action of the shear is potentially dangerous to bystanders.
- 3) The operator should ensure that no other persons are present in the working area.
- 4) The operator should be aware for the intended use for the shear grab. The shearing of silage, grass or maize from the face of a silage clamp.
- 5) The operator must not use this product for alternate uses, eg lifting
- 6) The shear grab must be stored and transported with the grab closed.
- 7) **Remove transport bolts upon delivery.**

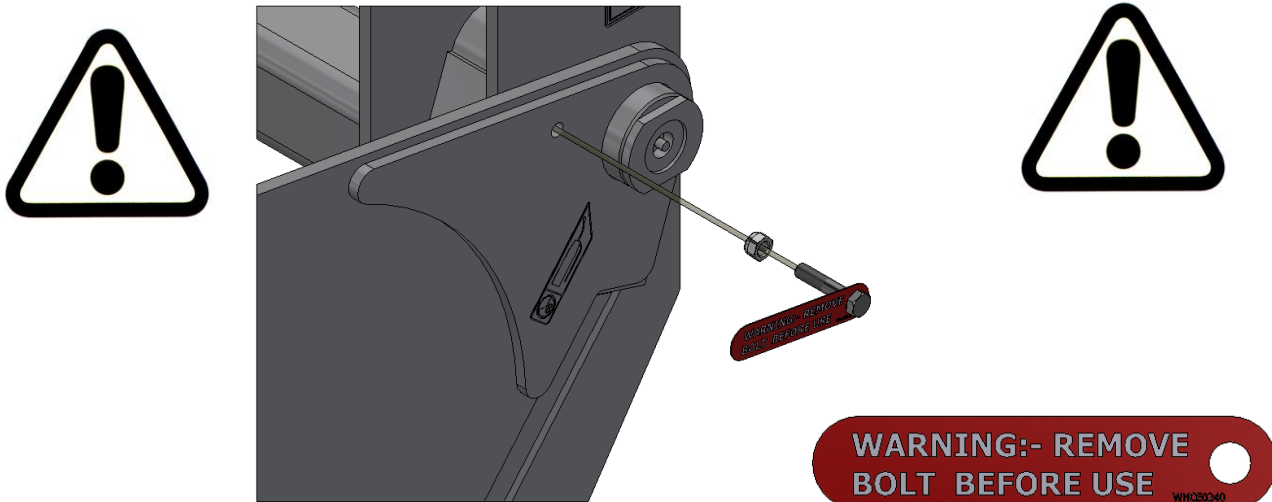

4.2. PREPARATION

- 1) **Ensure transport bolts are removed prior to use.**
- 2) Each shear grab is designed and manufactured to function on a specific machine.
- 3) Ensure the weight of the shear and the load do not exceed the safe working load of the host machine.
- 4) The operator should ensure that the shear grab is the correct unit for the host machine by checking the attachment identification plate which is attached to the rear of the attachment.
- 5) Connection of the shear grab and the hydraulic hoses should be carried out as per the instructions in the host machines manual.
- 6) The shear grab should operate in a level plane.

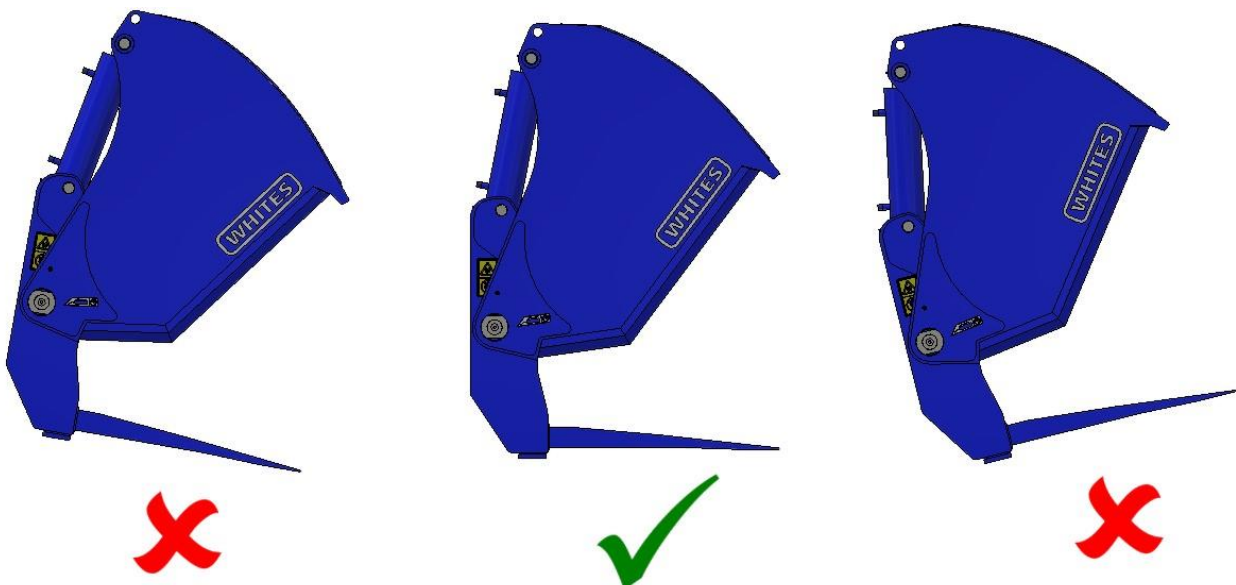

4.3. OPERATION

- 1) This shear grab is intended to smoothly cut a section from a silage clamp, whilst leaving a smooth face to stop air ingress.
- 2) With tines flat, level with the floor, operate the auxiliary hydraulics to open the grab fully.
- 3) Drive hard into the clamp face, at a depth not exceeding the grab opening.
- 4) Operate the auxiliary hydraulics closing the grab, so that the knives cut down through the silage. Do not let the tines raise, use the loader arms to apply pressure downwards.
- 5) Once the grab is fully closed, crowd the shear grab back, and raise away from the cut faces.
- 6) Reverse away from the clamp and lower the shear grab as low as it will go to clear the floor to improve stability.
- 7) Cut across the clamp face from 1 side, to ensure minimal face is exposed to air.
- 8) To empty the shear grab, lift the tines clear of the area, operate the auxiliary hydraulics to open the grab, then dump the contents. The silage will fall out.

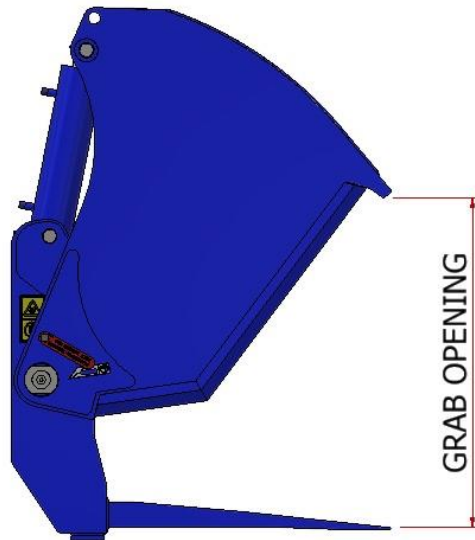

NEVER TRY TO DISCHARGE THE ATTACHMENT WHEN GRAPPLE IS CLOSED, AS THIS MAY CAUSE THE HOST MACHINE TO TIP FORWARD WITH RISK OF SERIOUS INJURY TO THE OPERATOR.



4.4. MAINTAINANCE

DAILY OR EVERY 8 HOURS OPERATION

- Grease all hinge and Hydraulic swivel points with molydisulphide grease.
- Check for damage or leakage of hydraulic cylinders, hoses and fittings.
- Check blades are clean and very sharp, if necessary sharpen by draw filing, with a 2nd cut file.
- Do NOT sharpen with a grinder as the heat will weaken the blades.
- Check for material build up inside the product and remove.
- Check all bolts & nuts are tight.



WEEKLY

- Sharpen blades weekly by draw filing, with a 2nd cut file.

MONTHLY

- Check grapple, tines, hinges and assembly for wear and damage.
- Replace damaged or worn components immediately to ensure safe and efficient operations of this attachment.

PARTS LIST

SHGX1600

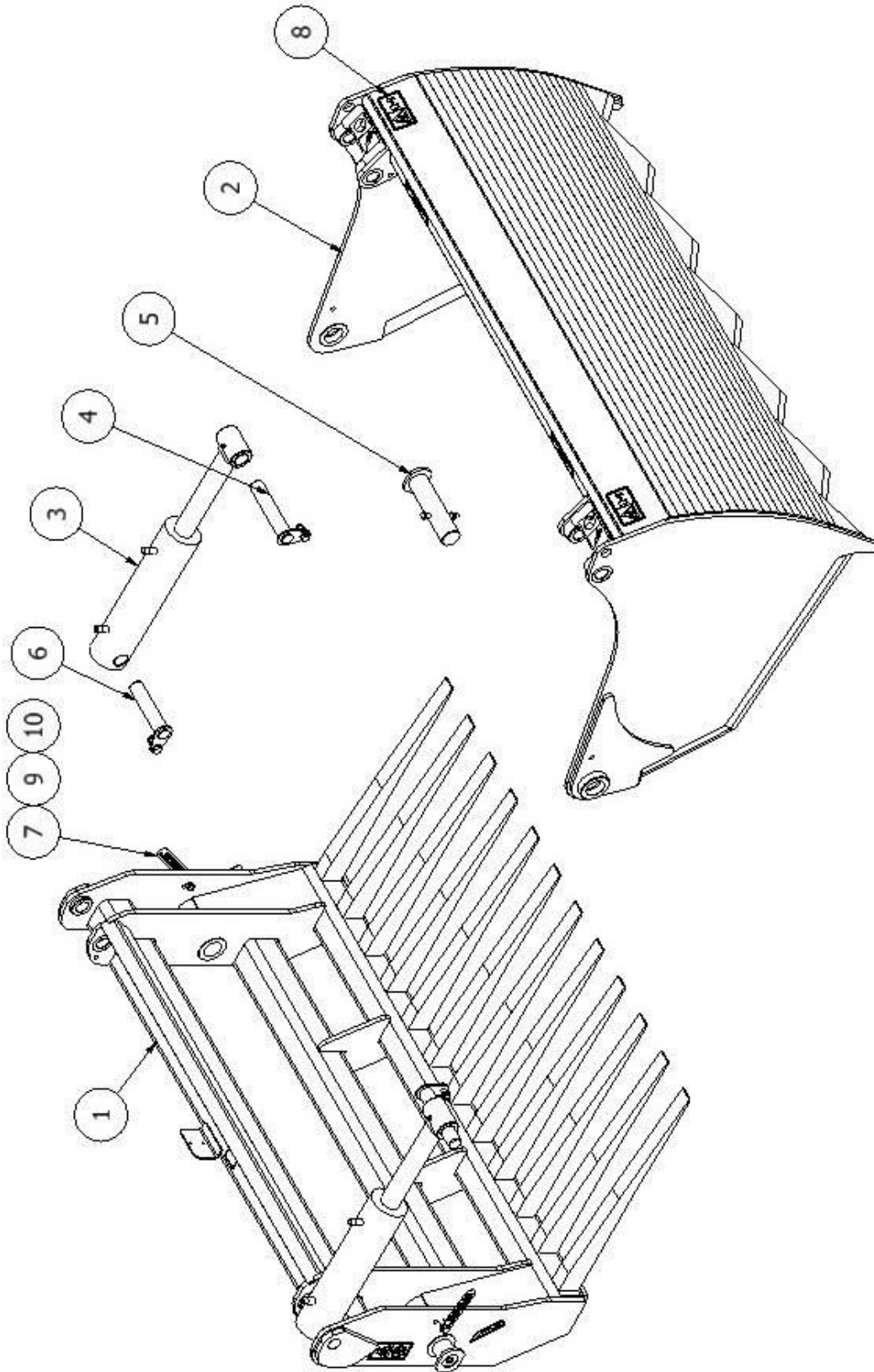

ITEM QTY	PART No.	DESCRIPTION	ITEM QTY	PART No.	DESCRIPTION
1	SHGX1600FR	1600MM SHEAR GRAB - FRAME	7	WHCE0240	SAFETY TAG - REMOVE TRANSPORT BOLT
2	SHGX1600SH	1600MM SHEAR GRAB - SHEAR	8	WH-CE-SHGX	DECAL SHEET - SHEAR GRAB (SHGX1600/SHGX1900)
3	CWPP0102	HYDRAULIC CYLINDER	9	ZB120060	M12 ZINC BOLT 60MM GR8.8
4	WHBP0931-KIT	RAM PIN - KIT	10	ZY120000	M12 NYLOC ZINC NUT GR8.8
5	WHBP1002-KIT	HINGE PIN - KIT	11	HKSHG1600	HOSE KIT - SHGX1600
6	WHBP1009-KIT	RAM PIN - KIT			

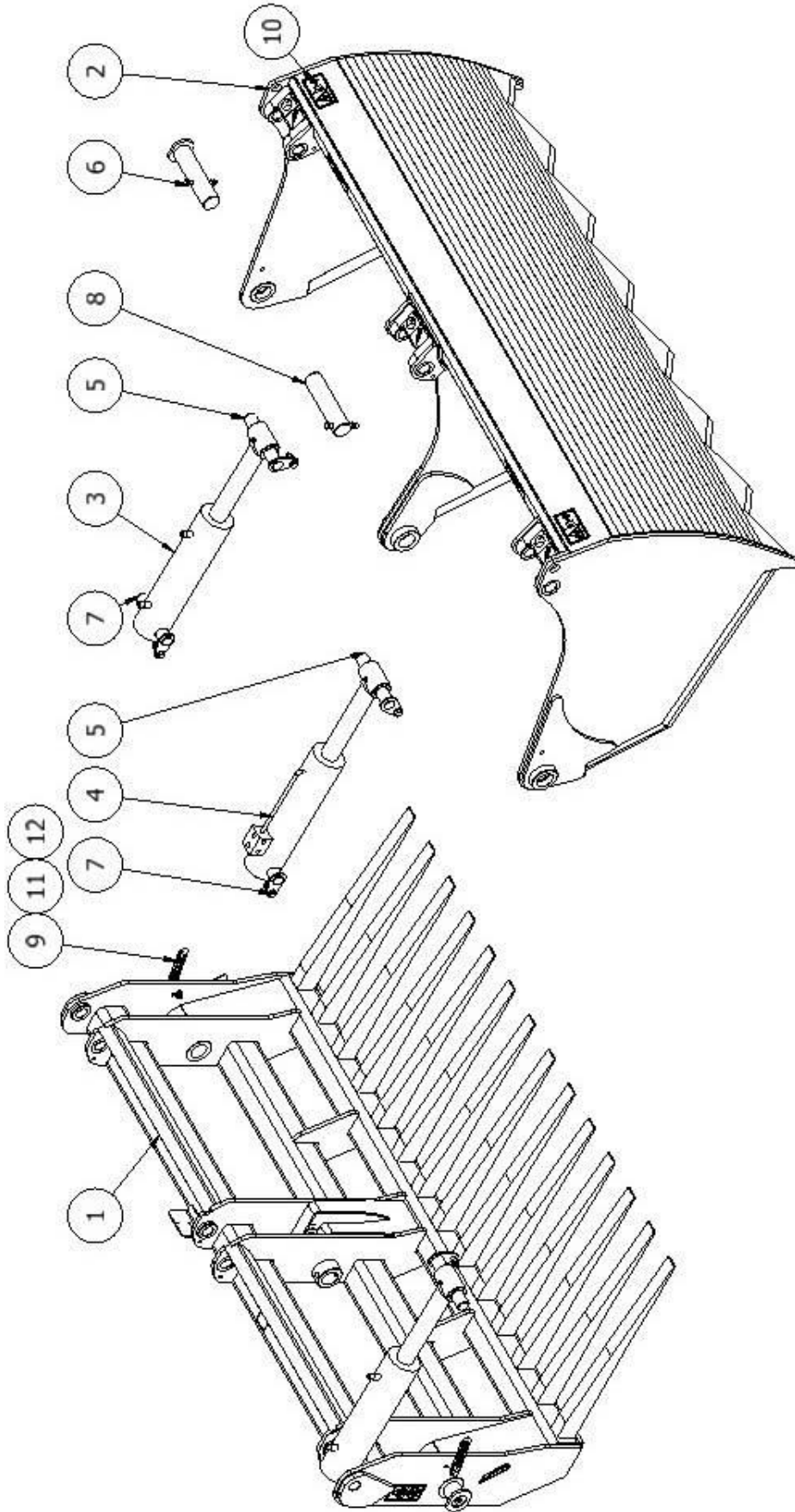

ITEM QTY	PART No.	DESCRIPTION	ITEM QTY	PART No.	DESCRIPTION
1	SHGX1900FR	1900MM SHEAR GRAB - FRAME	8	WHBP1024-KIT	PIN - CENTRE HINGE PIN KIT
2	SHGX1900SH	1900MM SHEAR GRAB - SHEAR	9	WHCE0240	SAFETY TAG - REMOVE TRANSPORT BOLT
3	CWPP0102	HYDRAULIC CYLINDER	10	WH-CE-SHGX	.DECAL SHEET - SHEAR GRAB (SHGX1600)/SHGX1900
4	CWPP0103	HYDRAULIC CYLINDER - CENTRAL	11	ZB120060	M12 ZINC BOLT 60MM GR8.8
5	WHBP0031-KIT	RAM PIN - KIT	12	ZY120000	M12 NYLOC ZINC NUT GR8.8
6	WHBP1002-KIT	HINGE PIN - KIT	13	HKSHG1900.	HOSE KIT - SHGX1900
7	WHBP1009-KIT	RAM PIN - KIT			