

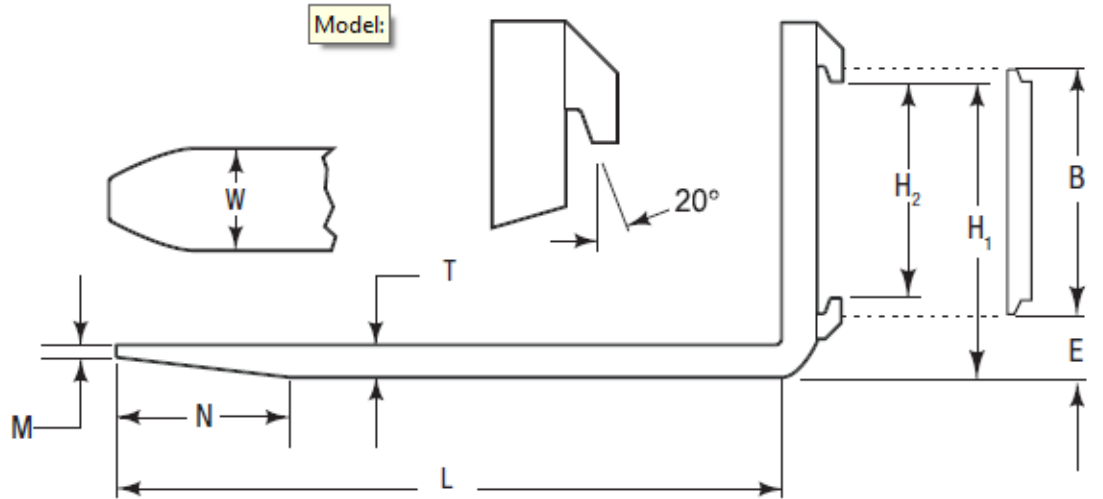

FEM/ITA FORKS

Fork Capacity Required per pair:	<input type="text"/>	kg	Load Centre:	<input type="text"/>	mm
----------------------------------	----------------------	----	--------------	----------------------	----

B:	<input type="text"/>
W:	<input type="text"/>
T:	<input type="text"/>
L:	<input type="text"/>
H1:	<input type="text"/>
H2:	<input type="text"/>
E:	<input type="text"/>
N:	<input type="text"/>
M:	<input type="text"/>



Standard ITA/FEM Dimensions

NB: Forks do not necessarily conform to all dimensions in all instances. Please complete list above.

Please tick if ALL dimensions are correct *



TUBE / PIN TYPE FORKS

Fork Capacity Required per pair:	kg	Load Centre:	mm
----------------------------------	----	--------------	----

Bar/Pin Dia:
Tube ID:
Tube OD:
Inset B:
Rear Shank C:
Offset C:
Inline D:
H:
W:
T:
L:
P:
M:
N:
H:
I:
J:
K:
L:

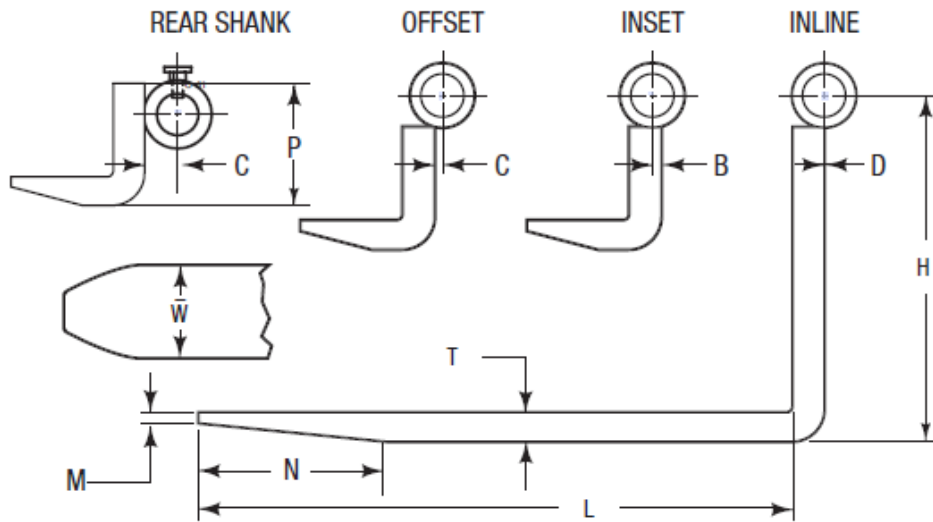

Is Tube Slotted? Yes No
 If No, see note 5 below.
 If Yes, please show dimensions below.

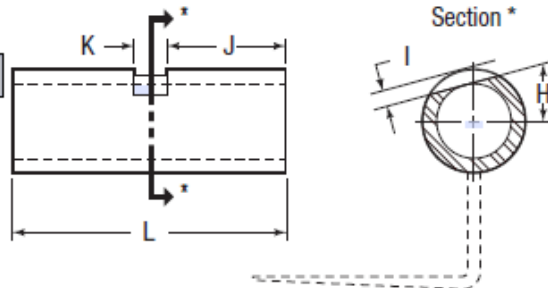

General Notes:

1. Standard toes and tapers will be supplied, unless specific dimensions are shown at M and N above. N.B. Non-Standard requirements MAY be more expensive.
2. Datum point for tube mounting is taken as distance between back of fork heel/front face of bottom carriage rail and vertical centre line of tube/bar.
3. Tube ID should equal bar diameter plus acceptable tolerance.
4. Tube OD: Excessively thin walls on the tube may require use of special tube material at extra cost. We will advise you of such instances.
5. Slots in tube: Under the provisions of machinery directive 2006/42/EC, "means shall be provided to prevent unintentional lateral displacement of the fork arms on the fork carrier." If no slot is shown above, it is your responsibility to ensure an